



802360 Replacement Motors

INSTALLATION INSTRUCTIONS

APPLICATION

The 802360 Replacement Motors are for use with V4043, V4044 Fan Coil Valves and V8043, V8044 Zone Valves. See Table 1.

Table 1. Replacement Motors

Replacement Motor	Voltage/Frequency	Zone Valve Used With	Current Draw
802360JA	24 V, 50/60 Hz	V8043, V8044	0.32 A
802360LA	120 V, 60 Hz	V4043, V4044	0.08 A
802360MA	208 V, 60 Hz		0.044 A
802360NA	220 V, 50 Hz/ 240 V, 60 Hz		0.042 A
802360QA	277 V, 60 Hz		0.037 A

INSTALLATION

When Installing This Product...

1. Read these instructions carefully. Failure to follow them could damage the product or cause a hazardous condition.
2. Check the ratings given in the instructions and on the product to make sure the product is suitable for your application.
3. Installer must be a trained, experienced service technician.
4. After installation is complete, check out product operation as provided in these instructions.



CAUTION

Disconnect power supply before connecting wiring to prevent electrical shock or equipment damage.

1. Remove powerhead cover (see Fig. 1).
2. Remove old motor from powerhead (Fig. 2):
 - Clip the motor leadwires off close to the old motor.
 - Strip these leadwires 1/2 in. [13 mm].
 - Remove the mounting screw.
 - Lift the old motor out of the powerhead.

3. Install new motor in powerhead:
 - Fit tab on motor under slot on powerhead (Fig. 2).
 - Secure motor in place with the mounting screw removed in Step 2.
 - Splice leadwires from new motor to clipped wires from old motor. Use the two solderless connectors provided.
4. Replace powerhead cover.

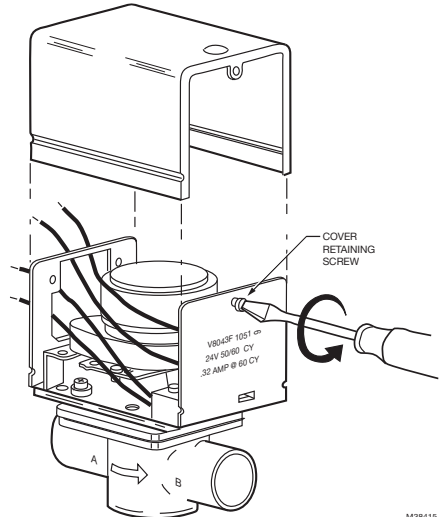

Fig. 1. Remove powerhead cover.



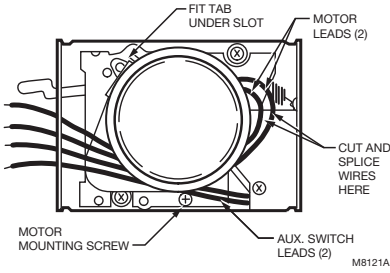

Fig. 2. Replace powerhead motor.

CHECKOUT

1. Raise the set point on the zone thermostat about 10° F [6° C] above room temperature to initiate a call for heat.
2. Observe all control devices—the valve should open and the auxiliary switch should make the circuit to the circulator or other valve at the end of the opening stroke.
3. Lower the set point on the zone thermostat about 10° F [6° C] below room temperature.
4. Observe the control devices—the valve should close and auxiliary equipment should stop. The valve should run smoothly and positively from closed to open to closed position.



Resideo Technologies, Inc.
1985 Douglas Drive North, Golden Valley, MN 55422
1-800-468-1502

***.resideo.com 69-0481-04 M.S. Rev. 03-20 | Printed in United States

© 2020 Resideo Technologies, Inc. All rights reserved.

The Honeywell Home trademark is used under license from Honeywell International, Inc. This product is manufactured by Resideo Technologies, Inc. and its affiliates.